



**RECORD OF TITLE
UNDER LAND TRANSFER ACT 2017
FREEHOLD**

**Guaranteed Search Copy issued under Section 60 of the Land
Transfer Act 2017**



R. W. Muir
Registrar-General
of Land

Identifier **808940**
Land Registration District **Wellington**
Date Issued 24 April 2020

Prior References

482456

Estate Fee Simple
Area 230.7449 hectares more or less
Legal Description Lot 102 Deposited Plan 517369

Registered Owners

East Leigh Limited

Interests

Subject to Section 8 Mining Act 1971 (affects part formerly Lot 1 DP 46909 & Part Lot 1 DP 41142)
Subject to Section 168A Coal Mines Act 1925 (affects part formerly Lot 1 DP 46909 & Part Lot 1 DP 41142)
Subject to Section 11 Crown Minerals Act 1991 (affects part formerly Part Section 1054 Whareama District)
Subject to Part IV A Conservation Act 1987 (affects part formerly Part Section 1054 Whareama District)
Subject to a right of way over part marked BC on DP 517369 specified in Easement Certificate 242634.1 - 1.1.1870 at 12:00 am
Appurtenant to part formerly Part Section 1054 Whareama District is a right of way specified in Easement Certificate 242634.1 - 5.1.1978 at 1:31 pm
Land Covenant in Transfer B215710.1 - 30.1.1992 (affects part formerly Lot 4 DP 80162)
Appurtenant to part formerly Lot 1 DP 46909 & Part Lot 1 DP 41142 is a right to convey water created by Transfer B475081.4 - 2.11.1995 at 3.35 pm
Subject to a right to take and convey water over part marked Z on DP 517369 created by Transfer B475081.4 - 2.11.1995 at 3.35 pm
Subject to an electricity easement (in gross) over part marked BD on DP 517369 in favour of Powerco Limited created by Transfer 5816522.1 - 27.11.2003 at 9:00 am
7549127.3 Consent Notice pursuant to Section 221 Resource Management Act 1991 - 21.9.2007 at 9:00 am
Subject to a right (in gross) to drain stormwater over parts marked AA, AC, AD, F, G and D on DP 517369 in favour of Masterton District Council created by Easement Instrument 7549127.5 - 21.9.2007 at 9:00 am
The easements created by Easement Instrument 7549127.5 are subject to Section 243 (a) Resource Management Act 1991
Appurtenant hereto is a right of way, right to drain sewage, right to convey electricity, telecommunications and computer media created by Easement Instrument 7549127.6 - 21.9.2007 at 9:00 am
The easements created by Easement Instrument 7549127.6 are subject to Section 243 (a) Resource Management Act 1991
Subject to a right to drain stormwater over parts marked AC, AD, P and Y on DP 517369 created by Easement Instrument 7549127.7 - 21.9.2007 at 9:00 am
The easements created by Easement Instrument 7549127.7 are subject to Section 243 (a) Resource Management Act 1991

Identifier**808940**

8081041.6 Consent Notice pursuant to Section 221 Resource Management Act 1991 - 23.2.2009 at 9:00 am

Subject to a right to drain stormwater over parts marked AH, CD and H on DP 517369 created by Easement Instrument 8081041.11 - 23.2.2009 at 9:00 am

The easements created by Easement Instrument 8081041.11 are subject to Section 243 (a) Resource Management Act 1991

Subject to a right (in gross) to drain stormwater over parts marked BE, AH and CD on DP 517369 in favour of Masterton District Council created by Easement Instrument 8081041.12 - 23.2.2009 at 9:00 am

The easements created by Easement Instrument 8081041.12 are subject to Section 243 (a) Resource Management Act 1991

Appurtenant hereto is a right to convey electricity, telecommunications and computer media created by Easement Instrument 8081041.13 - 23.2.2009 at 9:00 am

The easements created by Easement Instrument 8081041.13 are subject to Section 243 (a) Resource Management Act 1991

8406468.1 Surrender of the right to take and convey water appurtenant to WN46A/245, WNA3/425, WN47A/548, WN47A/547, WN45A/268 & WN46A/245 created by Transfer B475081.4 - 8.10.2010 at 8:42 am

Subject to a right to take and convey water over part marked K on DP 517369 created by Easement Instrument 8406468.7 - 8.10.2010 at 8:42 am

The easements created by Easement Instrument 8406468.7 are subject to Section 243 (a) Resource Management Act 1991

8696643.15 Notice pursuant to Section 195(2) Climate Change Response Act 2002 - 15.2.2011 at 7:00 am

9115108.1 Notice pursuant to Section 195(2) Climate Change Response Act 2002 - - 5.7.2012 at 3:04 pm

Subject to a right of way, right to convey electricity, right to convey telecommunications and computer media over part marked D on DP 517369 created by Easement Instrument 9528527.8 - 21.10.2013 at 5:24 pm

The easements created by Easement Instrument 9528527.8 are subject to Section 243 (a) Resource Management Act 1991

Subject to a right (in gross) to drain sewage, right to convey electricity, right to convey telecommunications and computer media over part marked D on DP 517369 in favour of Masterton District Council created by Easement Instrument 9528527.9 - 21.10.2013 at 5:24 pm

Subject to a right of way, right to convey electricity, right to convey telecommunications and computer media over part marked D on DP 517369 created by Easement Instrument 9528527.10 - 21.10.2013 at 5:24 pm

The easements created by Easement Instrument 9528527.10 are subject to Section 243 (a) Resource Management Act 1991

11732442.2 Consent Notice pursuant to Section 221 Resource Management Act 1991 - 24.4.2020 at 11:53 am

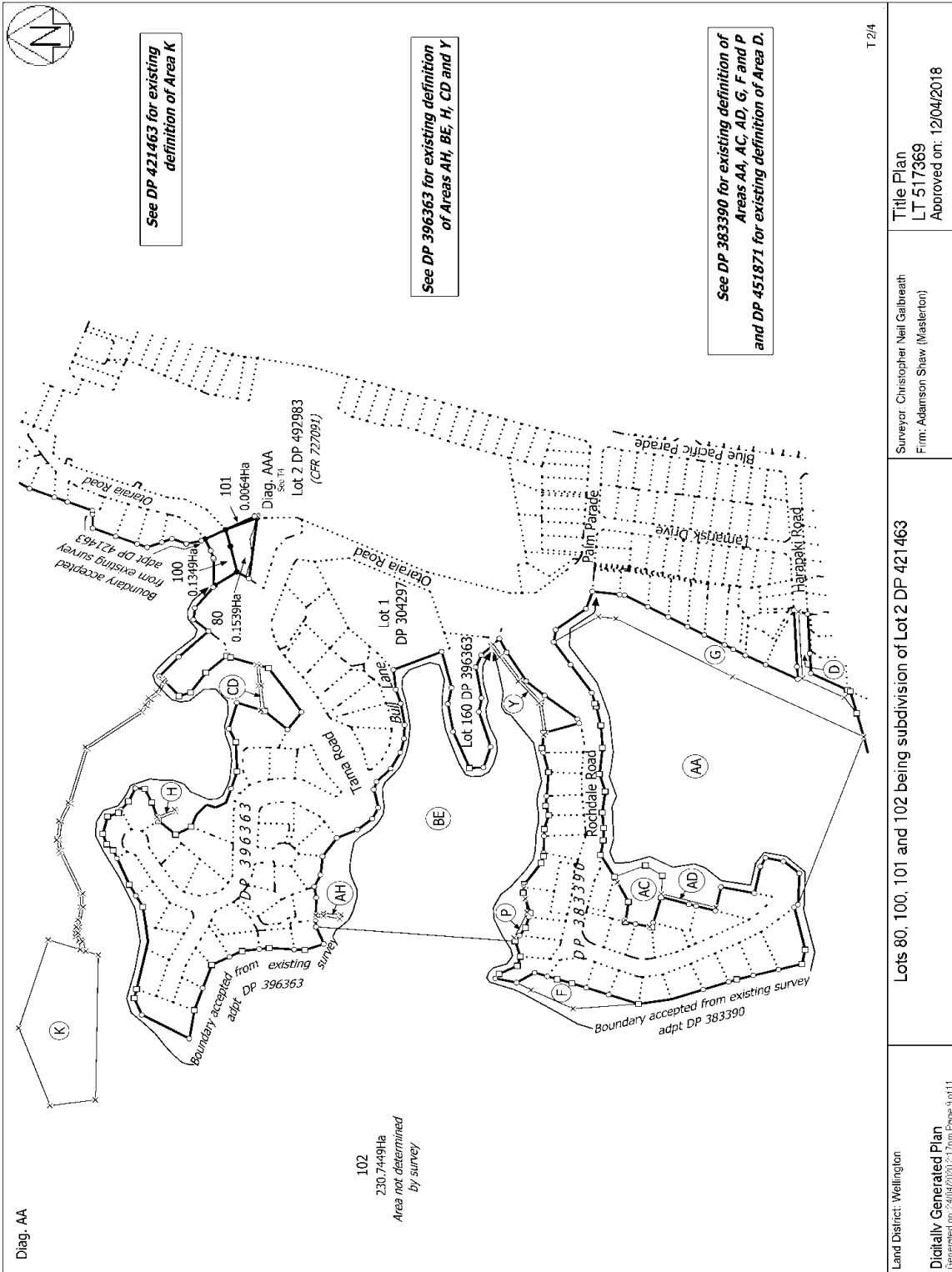

T 2/4

Land District: Wellington

Digitally Generated Plan
Generated on: 24/04/2018 11:17am Page 3 of 11

Surveyor: Christopher Neil Galbreath
Firm: Adamson Shaw (Masterlon)

Diag. AA

102
230.7449Ha
Area not determined by survey

100
0.1539Ha
Boundary accepted from existing survey adpt DP 396363

101
0.0064Ha
Diag. AAA
Sect 71
Lot 2 DP 492983
(CFR 227091)

Lot 1
DP 304297

Lot 160 DP 396363

DP 383390

Boundary accepted from existing survey adpt DP 383390

DP 396363

DP 421463
Boundary accepted from existing survey adpt DP 421463

AA, AH, BE, H, CD, Y, E, P, AC, AD, G, D

Oriaia Road, Tara Road, Bull Lane, Rochdale Road, Palm Parade, Harappa Road, Tamarisk Drive

See DP 421463 for existing definition of Area K

See DP 396363 for existing definition of Areas AH, BE, H, CD and Y

See DP 383390 for existing definition of Areas AA, AC, AD, G, F and P and DP 451871 for existing definition of Area D.

Diag. AA

Y

North Arrow

Land District: Wellington

Digitally Generated Plan
Generated on: 24/04/2018 11:17am Page 3 of 11

Surveyor: Christopher Neil Galbreath
Firm: Adamson Shaw (Masterlon)

Title Plan
LT 517369
Approved on: 12/04/2018

Lots 80, 100, 101 and 102 being subdivision of Lot 2 DP 421 463

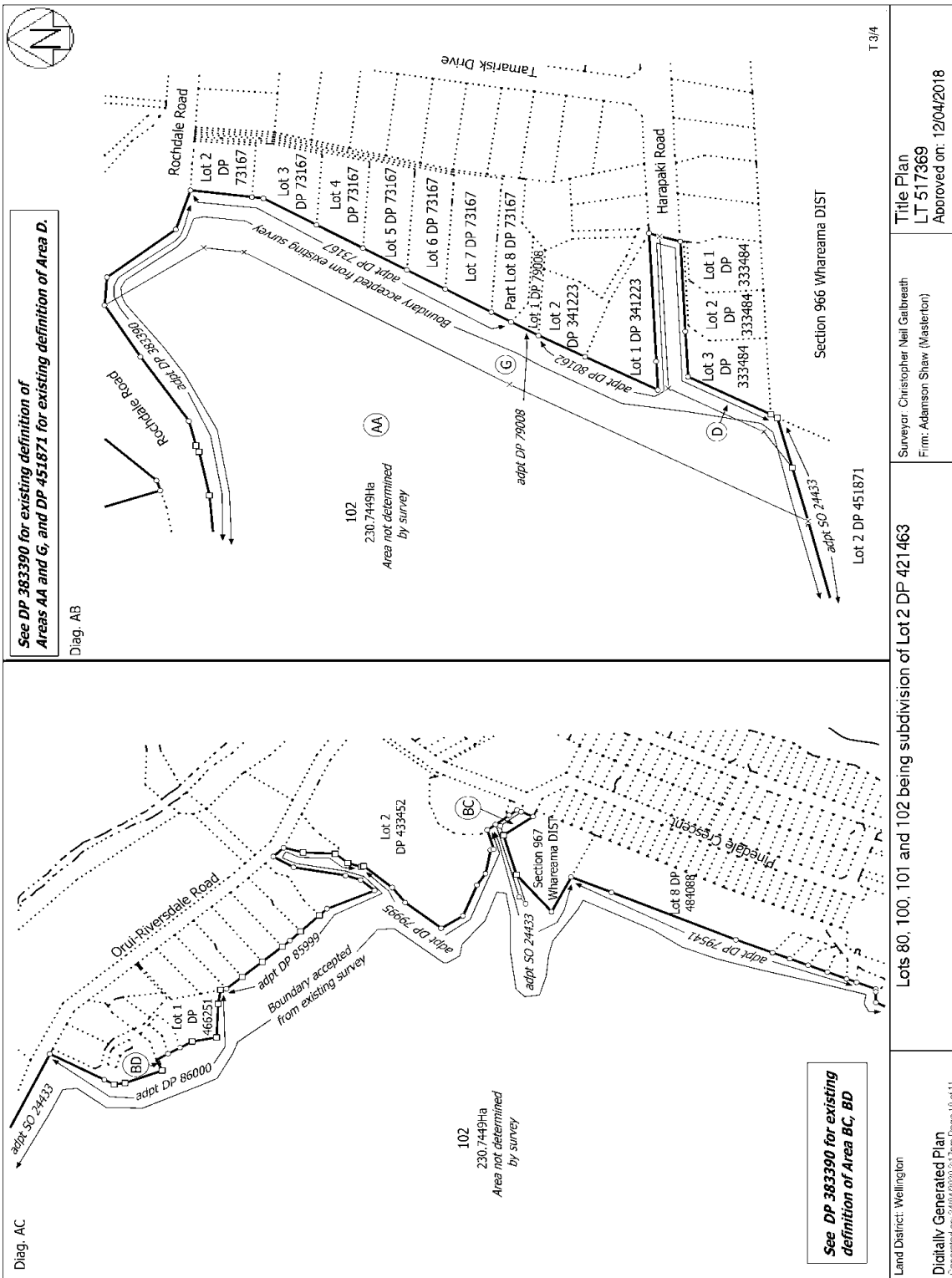

<p>Land District: Wellington</p>	<p>Lots 80, 100, 101 and 102 being subdivision of Lot 2 DP 421 463</p>	<p>Title Plan LT 517369 Approved on: 12/04/2018</p>
<p>Digitally Generated Plan Generated on: 24/04/2020 5:17pm Page 10 of 11</p>	<p>Surveyor: Christopher Neil Galbreath Firm: Adamson Shaw (Masterlon)</p>	<p>T 3/4</p>